

IMPORTANT SAFETY AND INSTALLATION INSTRUCTIONS

WARNING: Risk of fire and electrical shock. This product is to be installed by a qualified electrician only.

CAUTION: When using electrical equipment, basic safety precautions should always be followed including the following: Read all instructions carefully before installation and save

for future use. Make sure installation and all connections are in accordance with National Electrical Code and any local regulations. To avoid possible electrical shock, be sure that power supply is turned off before installing or servicing this fixture. Servicing should be performed by qualified service personnel.

These instructions do not claim to cover all details or variations. When additional information is desired, please contact your SPI representative.

SPHERE PENDANTS

[1] Feed the lead wires or power cord from the light box through the lower stem and attach to sphere hanger plate and fixture coupling.

[2] Thread the upper stem (if equipped) into the fixture coupler and tighten locknut. Attach swivel ball to top of stem (AC cable is similar).

[3] Tilt the light engine box and sphere hanger plate to place in the sphere.

[4] Attach the sphere cover using the two flat head screws

[5] Attach swivel hanger plate to J-box (By others) and secure with hardware (By others) using auxiliary holes provided.

[6] Place swivel ball and stem (or AC cable) into swivel hanger and allow swivel ball to rest in the bottom of the swivel hanger. Position the swivel ball so the tab on the swivel hanger is positioned in the slot of the swivel ball.

[7] Make wire connections per local code. When connections are complete, secure the Canopy to the Swivel Hanger.

NOTE: Fixture must be supported with structural members (By other) in addition to J-box

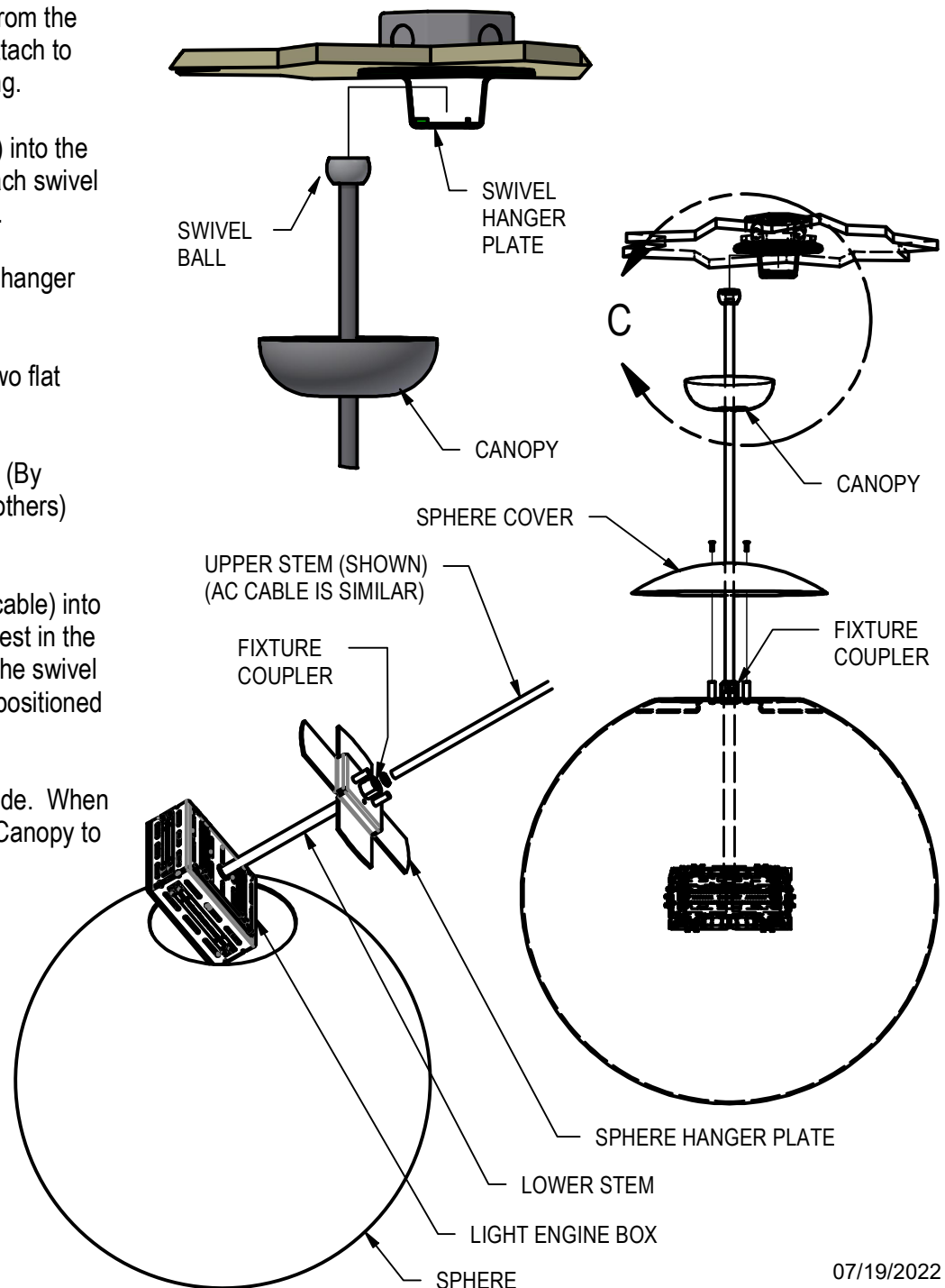

07/19/2022
IS96600X