

IMPORTANT SAFETY AND INSTALLATION INSTRUCTIONS

WARNING: Risk of fire and electric shock. This product is to be installed by a qualified electrician only.

CAUTION: When using electrical equipment, basic safety precautions should always be followed including the following: Read all instructions carefully before installation and save

for future use. Make sure installation and all connections are in accordance with National Electrical Code and any local regulations. To avoid possible electrical shock, be sure that power supply is turned off before installing or servicing this fixture. Servicing should be performed by qualified service personnel.

These instructions do not claim to cover all details or variations. When additional information is desired, please contact your SPI representative.

ARM SCONCE

- #1 Locate mounting holes as per drawing
- #2 Remove 2 6-32 screws from cover plate and slide cover plate exposing mounting plate
- #3 Feed wires from the fixture and the supply wires through one of the access holes in the mounting plate.
- #4 Secure mounting plate to wall
*** Make sure mounting plate is level ***
- #5 Wire fixture
- #6 Slide cover plate over mounting plate and secure with 2 6-32 screws
- #7 Rotate latch clockwise 90 degrees and lift lamp tray, install lamp
- #8 Lower lamp tray and rotate latch 90 degrees counterclockwise
- #9 Loosen 2 glass lens clips and remove glass lens. Install lamp and replace glass lens and secure clips.

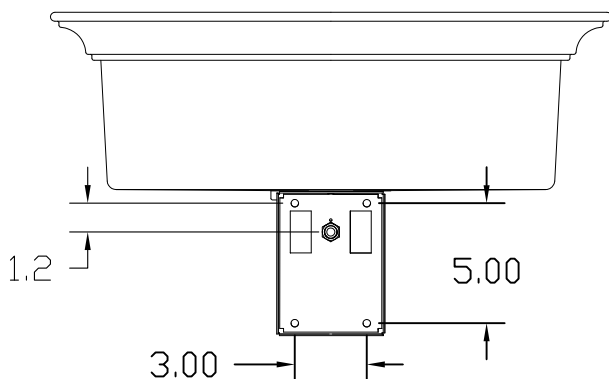
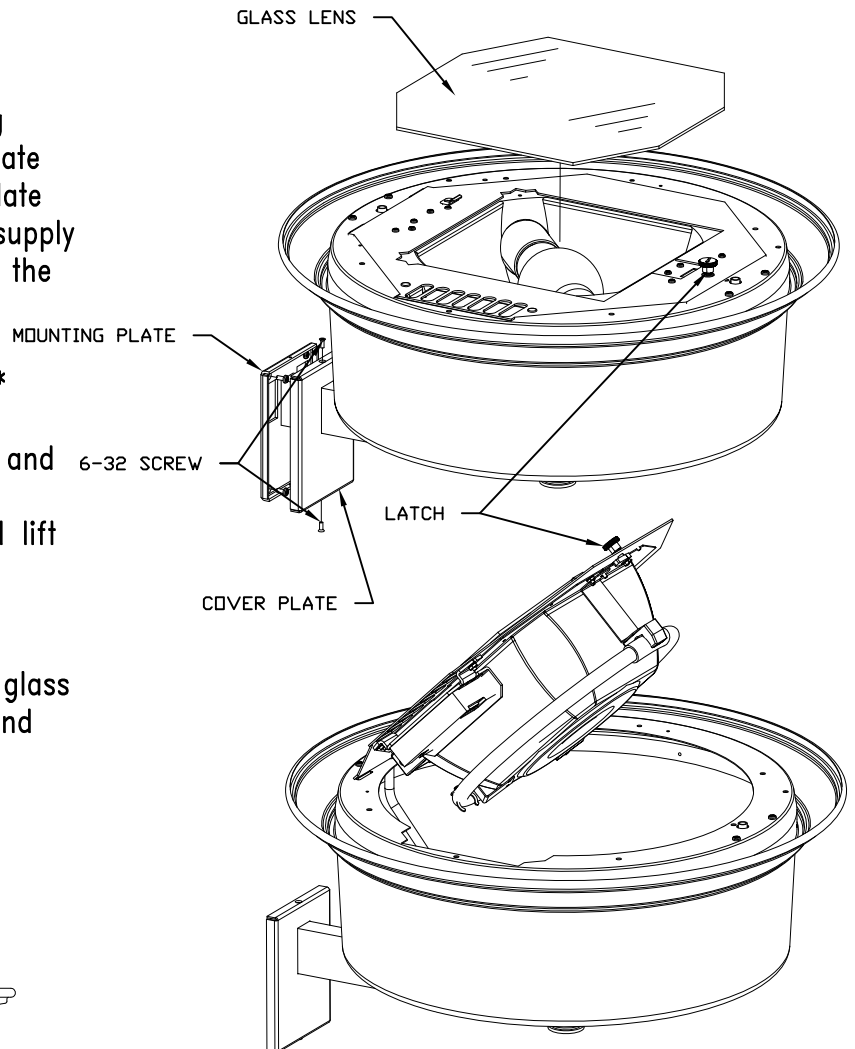

11/26/13
IS42576X