

# IMPORTANT SAFETY AND INSTALLATION INSTRUCTIONS

**WARNING:** Risk of fire and electrical shock. This product is to be installed by a qualified electrician only.

**CAUTION:** When using electrical equipment, basic safety precautions should always be followed including the following: Read all instructions carefully before installation and save

for future use. Make sure installation and all connections are in accordance with National Electrical Code and any local regulations. To avoid possible electrical shock, be sure that power supply is turned off before installing or servicing this fixture. Servicing should be performed by qualified service personnel.

These instructions do not claim to cover all details or variations. When additional information is desired, please contact your SPI representative.

---

## EASTLAND WALL MOUNT INSTALLATION INSTRUCTIONS

---

### Installation:

- [A] Attach crossbar to jbox using hardware (by others).
- [B] Make necessary lead wire connections and push splices into jbox.
- [C] Slide housing over studs attached to crossbar and tighten knurl nuts to secure housing.

### To Relamp:

- [A] Install lamp, which must be per Replacement Lamp Label.

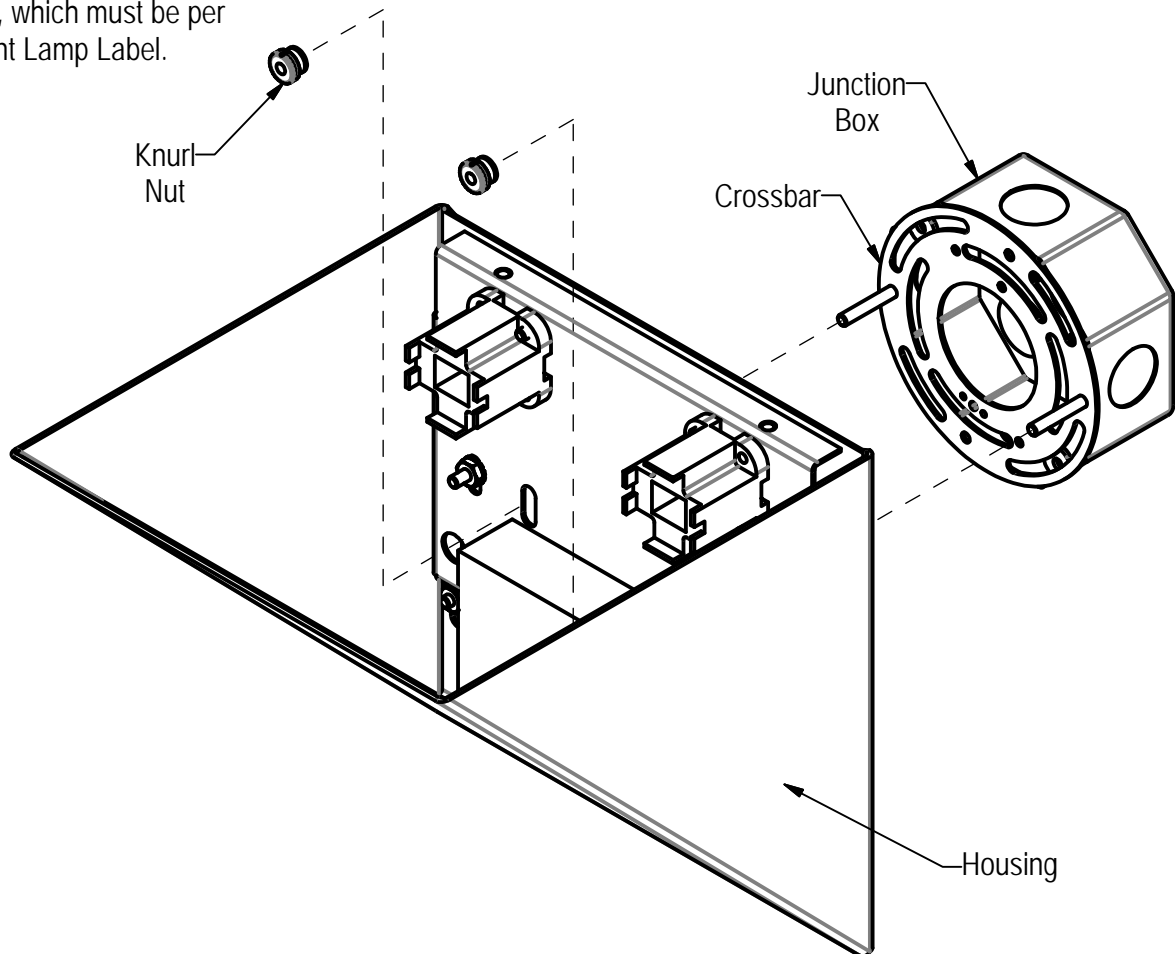

12/4/13  
IS52267X