

IMPORTANT SAFETY AND INSTALLATION INSTRUCTIONS

WARNING: Risk of fire and electrical shock. This product is to be installed by a qualified electrician only.

CAUTION: When using electrical equipment, basic safety precautions should always be followed including the following: Read all instructions carefully before installation and save

for future use. Make sure installation and all connections are in accordance with National Electrical Code and any local regulations. To avoid possible electrical shock, be sure that power supply is turned off before installing or servicing this fixture. Servicing should be performed by qualified service personnel.

These instructions do not claim to cover all details or variations. When additional information is desired, please contact your SPI representative.

ARA - GENERAL (LED)

INSTALLATION:

1. ALIGN & SECURE MOUNTING PLATE TO J-BOX AT WALL/CEILING. AUXILIARY HOLES PROVIDED. SCREWS BY OTHERS.
2. MAKE ELECTRICAL CONNECTIONS PER CODE.
3. **FOR WET LOCATION ONLY:** APPLY A BEAD OF SILICONE ON SURFACES OF TOP AND BOTTOM FLANGES ON BACK SIDE. (SEE DIAGRAM BELOW)
4. SLIDE LUMINAIRE OVER MOUNTING PLATE STUDS.
5. CHECK ALIGNMENT AND SECURE LUMINAIRE TO MOUNTING PLATE WITH PROVIDED (4) GASKET RINGS AND NUTS (GASKET RINGS ON WET LOCATION FIXTURES ONLY).
6. **FOR WET LOCATION ONLY:** APPLY A BEAD OF SILICONE ALONG THE PERIMETER OF LUMINAIRE SPLICE BOX PROVIDING A WATER TIGHT SEAL AT THE BACK OF THE FIXTURE. (SEE DIAGRAM BELOW)

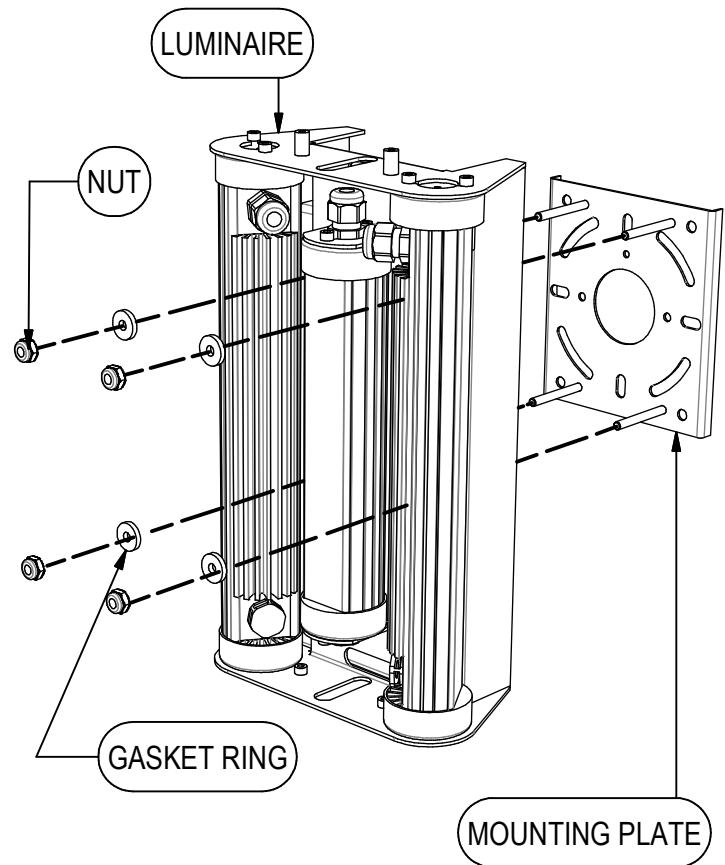
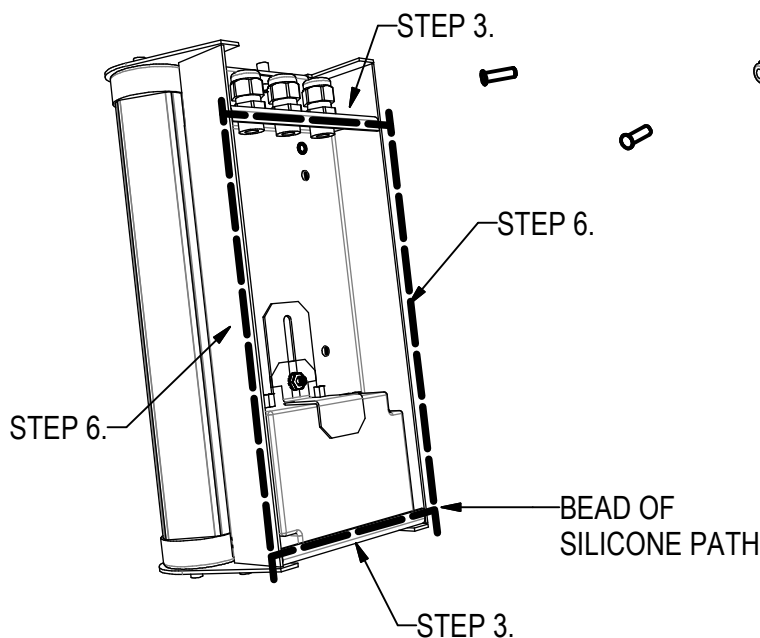

SILICONE AND GASKET RINGS
ONLY REQUIRED FOR WET
LOCATION FIXTURES

11/1/11
IS69925X