

# IMPORTANT SAFETY AND INSTALLATION INSTRUCTIONS

**WARNING:** Risk of fire and electrical shock. This product is to be installed by a qualified electrician only.

**CAUTION:** When using electrical equipment, basic safety precautions should always be followed including the following: Read all instructions carefully before installation and save

for future use. Make sure installation and all connections are in accordance with National Electrical Code and any local regulations. To avoid possible electrical shock, be sure that power supply is turned off before installing or servicing this fixture. Servicing should be performed by qualified service personnel.

These instructions do not claim to cover all details or variations. When additional information is desired, please contact your SPI representative.

## ECHO BLADE - SCN INSTALLATION

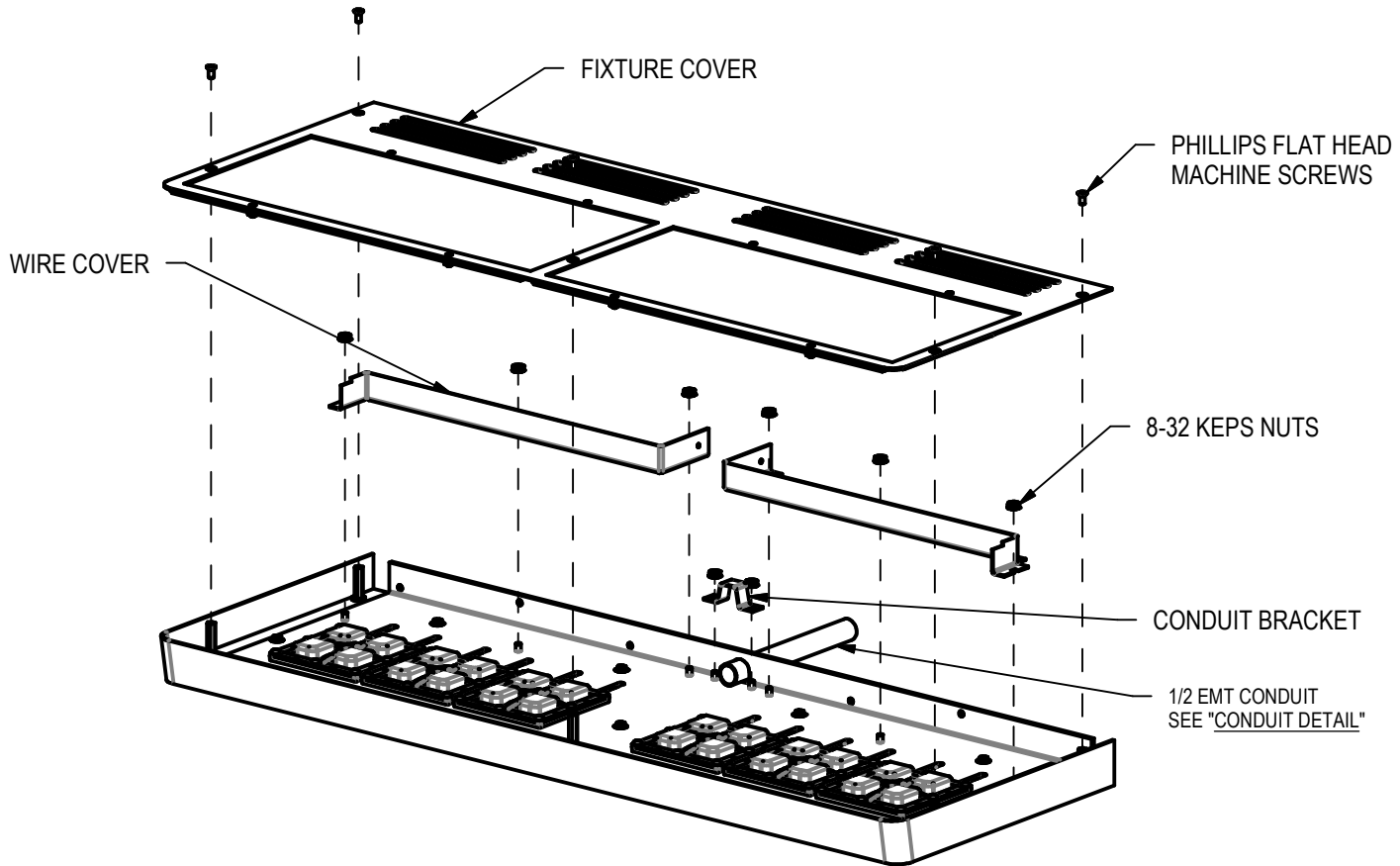

### INSTALLATION:

1. REMOVE FIXTURE COVER AND WIRE COVERS.
2. LOCATE MOUNTING SCREWS (BY OTHERS) USING PROVIDED DRAWING, OR BY USING FIXTURE AS TEMPLATE.
3. ATTACH FIXTURE TO WALL WITH #8 OR LARGER SCREWS (BY OTHERS). ALL MOUNTING HOLES MUST BE USED.
4. INSTALL CONDUIT BRACKET TO PREVENT MOVEMENT, AND REINSTALL WIRE COVERS.

(CONTINUED ON PAGE 2)

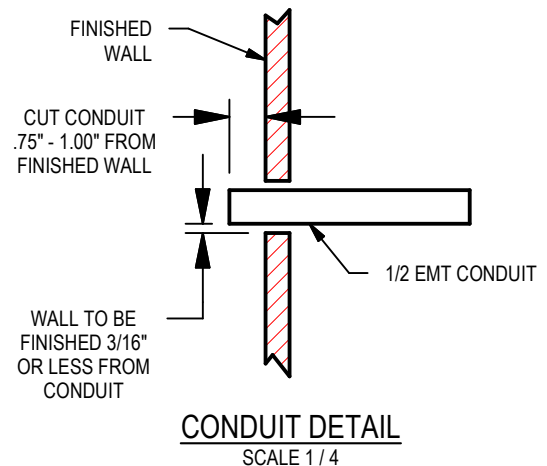

# IMPORTANT SAFETY AND INSTALLATION INSTRUCTIONS

**WARNING:** Risk of fire and electrical shock. This product is to be installed by a qualified electrician only.

**CAUTION:** When using electrical equipment, basic safety precautions should always be followed including the following: Read all instructions carefully before installation and save

for future use. Make sure installation and all connections are in accordance with National Electrical Code and any local regulations. To avoid possible electrical shock, be sure that power supply is turned off before installing or servicing this fixture. Servicing should be performed by qualified service personnel.

These instructions do not claim to cover all details or variations. When additional information is desired, please contact your SPI representative.

---

## ECHO BLADE - SCN INSTALLATION

---

(CONTINUED FROM PAGE 1)

5. MAKE ALL WIRE CONNECTIONS IN ACCORDANCE WITH STATE AND LOCAL CODE.

- CONNECT EACH OF THE RED (POS +) OR BLUE (NEG -) WIRES TO THE CORRESPONDING RED (POS +) OR BLUE (NEG -) WIRES OF THE POWER SUPPLIES USING 18 GAUGE OR LARGER REMOTE LEAD WIRES (BY OTHERS). THE POLARITY OF THE FIXTURE WIRES (POS +) OR (NEG -), MUST MATCH THE POLARITY OF THE POWER SUPPLY WIRES. WIRES LABELED WITH THE SAME SUPPLY NUMBER MUST BE ATTACHED TO THE SAME POWER SUPPLY.
- IN THE SUPPLIED REMOTE POWER SUPPLY ENCLOSURE CONNECT THE HIGH VOLTAGE SUPPLY LEADS TO THE BRANCH CIRCUIT. WIRE OR CAP-OFF DIMMING LEADS IF APPLICABLE.

6. REINSTALL FIXTURE COVER.

5/27/20  
IS107770X

# IMPORTANT SAFETY AND INSTALLATION INSTRUCTIONS

**WARNING:** Risk of fire and electrical shock. This product is to be installed by a qualified electrician only.

**CAUTION:** When using electrical equipment, basic safety precautions should always be followed including the following: Read all instructions carefully before installation and save

for future use. Make sure installation and all connections are in accordance with National Electrical Code and any local regulations. To avoid possible electrical shock, be sure that power supply is turned off before installing or servicing this fixture. Servicing should be performed by qualified service personnel.

These instructions do not claim to cover all details or variations. When additional information is desired, please contact your SPI representative.

## ECHO BLADE - SCN MOUNTING DIMENSIONS

### 15.5" WIDE FIXTURE MOUNTING HOLE DIMENSIONS

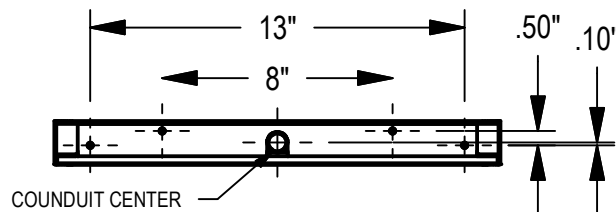

### 30.25" WIDE FIXTURE MOUNTING HOLE DIMENSIONS

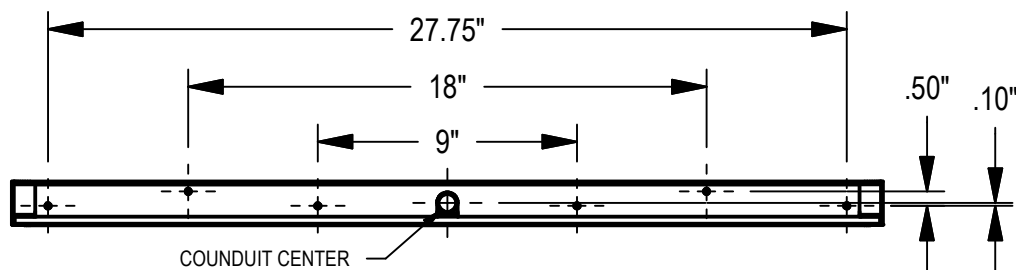

### 45" WIDE FIXTURE MOUNTING HOLE DIMENSIONS

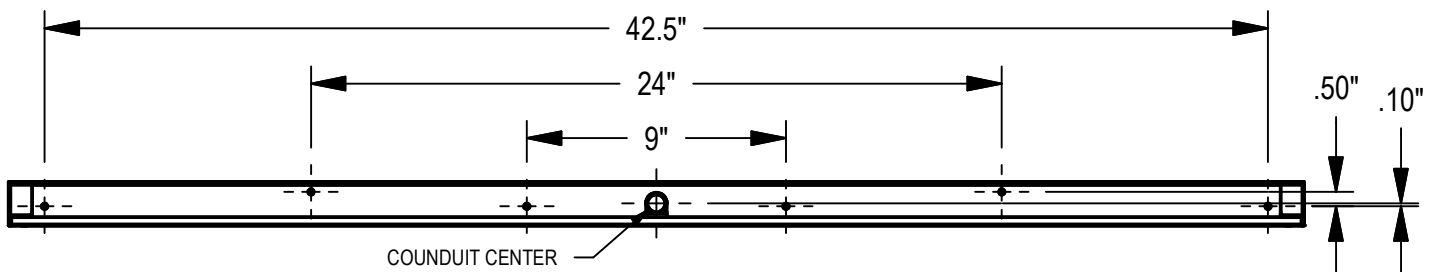

5/27/20  
IS107770X