

IMPORTANT SAFETY AND INSTALLATION INSTRUCTIONS

WARNING: Risk of fire and electrical shock. This product is to be installed by a qualified electrician only.

CAUTION: When using electrical equipment, basic safety precautions should always be followed including the following: Read all instructions carefully before installation and save

for future use. Make sure installation and all connections are in accordance with National Electrical Code and any local regulations. To avoid possible electrical shock, be sure that power supply is turned off before installing or servicing this fixture. Servicing should be performed by qualified service personnel.

These instructions do not claim to cover all details or variations. When additional information is desired, please contact your SPI representative.

CEILING / WALL MOUNT LED ASHLAND INSTALL INSTRUCTIONS

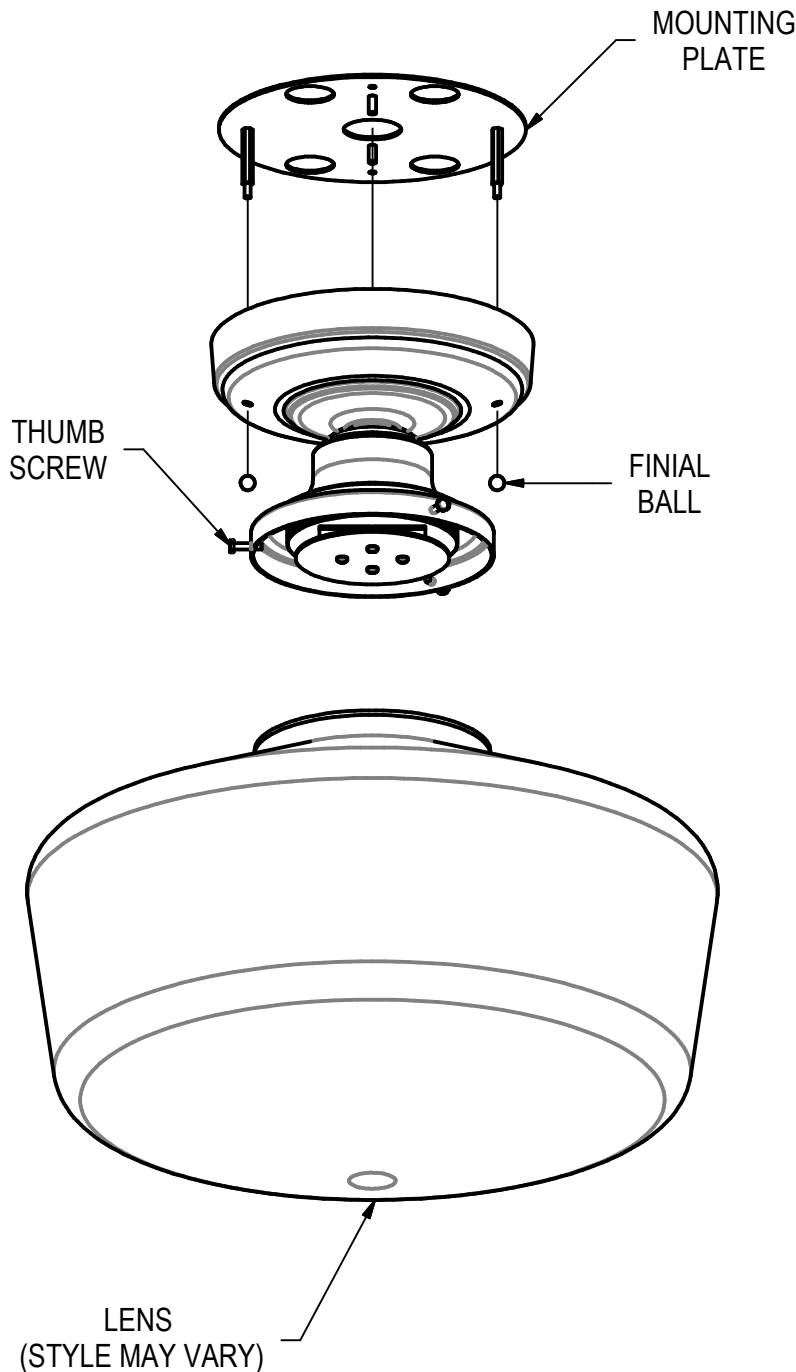

INSTALLATION STEPS:

1. UNPACK FIXTURE.
2. REMOVE MOUNTING PLATE FROM FIXTURE VIA FINIAL BALLS.
3. INSTALL MOUNTING PLATE TO J-BOX (HARDWARE BY OTHERS).
4. MAKE ALL ELECTRICAL CONNECTIONS TO FIXTURE IN ACCORDANCE WITH STATE AND LOCAL CODE.
5. REINSTALL FIXTURE TO MOUNTING PLATE.
6. INSTALL LENS TO FIXTURE, AND SECURE VIA THUMB SCREWS.

CEILING MOUNT

7/9/20
IS108468X

IMPORTANT SAFETY AND INSTALLATION INSTRUCTIONS

WARNING: Risk of fire and electrical shock. This product is to be installed by a qualified electrician only.

CAUTION: When using electrical equipment, basic safety precautions should always be followed including the following: Read all instructions carefully before installation and save

for future use. Make sure installation and all connections are in accordance with National Electrical Code and any local regulations. To avoid possible electrical shock, be sure that power supply is turned off before installing or servicing this fixture. Servicing should be performed by qualified service personnel.

These instructions do not claim to cover all details or variations. When additional information is desired, please contact your SPI representative.

CEILING / WALL MOUNT LED ASHLAND INSTALL INSTRUCTIONS

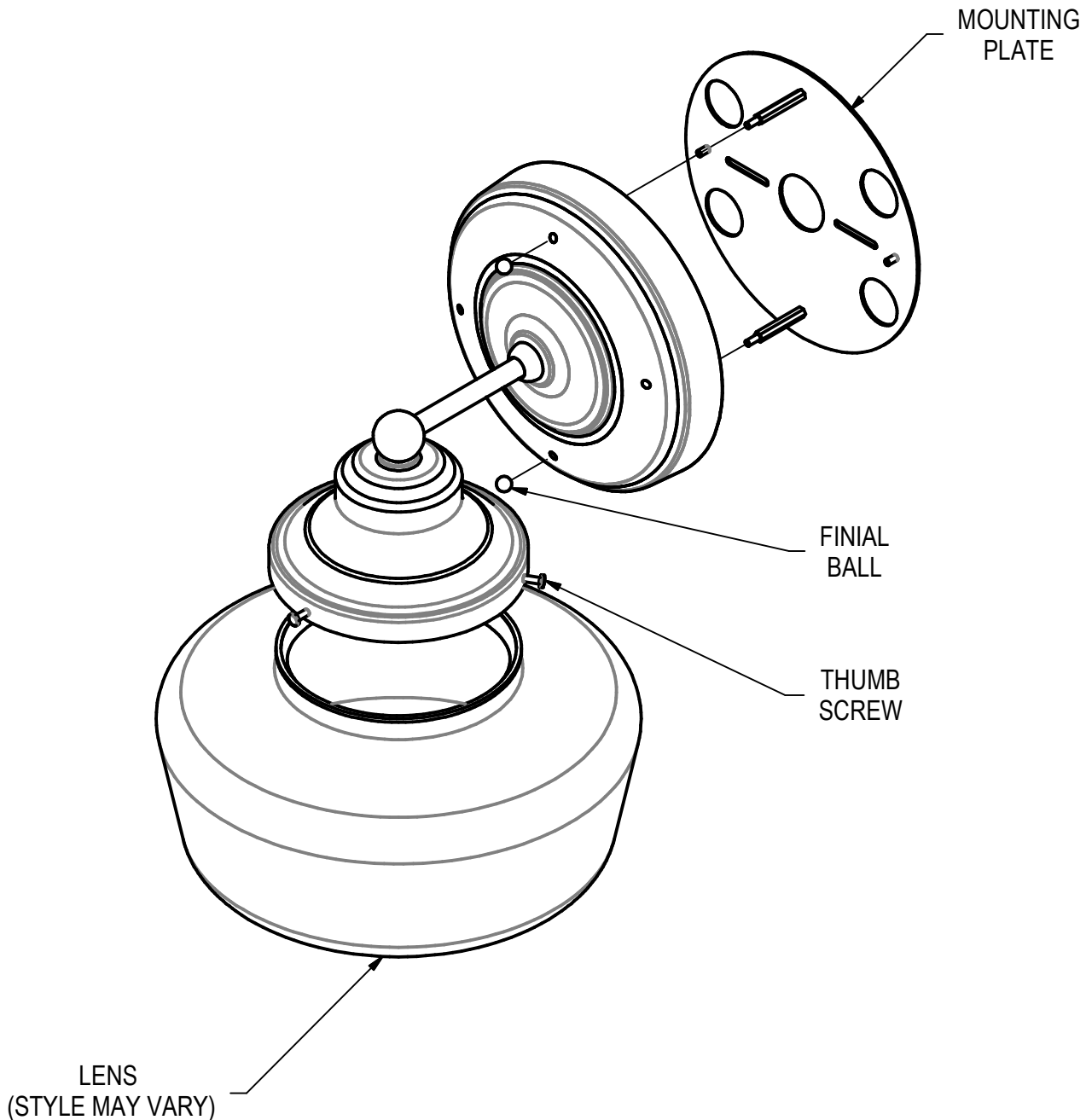

**WALL MOUNT
(INSTALL STEPS SAME AS CEILING MOUNT)**

7/9/20
IS108468X