

# IMPORTANT SAFETY AND INSTALLATION INSTRUCTIONS

**WARNING:** Risk of fire and electrical shock. This product is to be installed by a qualified electrician only.

**CAUTION:** When using electrical equipment, basic safety precautions should always be followed including the following: Read all instructions carefully before installation and save

for future use. Make sure installation and all connections are in accordance with National Electrical Code and any local regulations. To avoid possible electrical shock, be sure that power supply is turned off before installing or servicing this fixture. Servicing should be performed by qualified service personnel.

These instructions do not claim to cover all details or variations. When additional information is desired, please contact your SPI representative.

## FLANGE HOUSING - GENERAL CONSTRUCTION

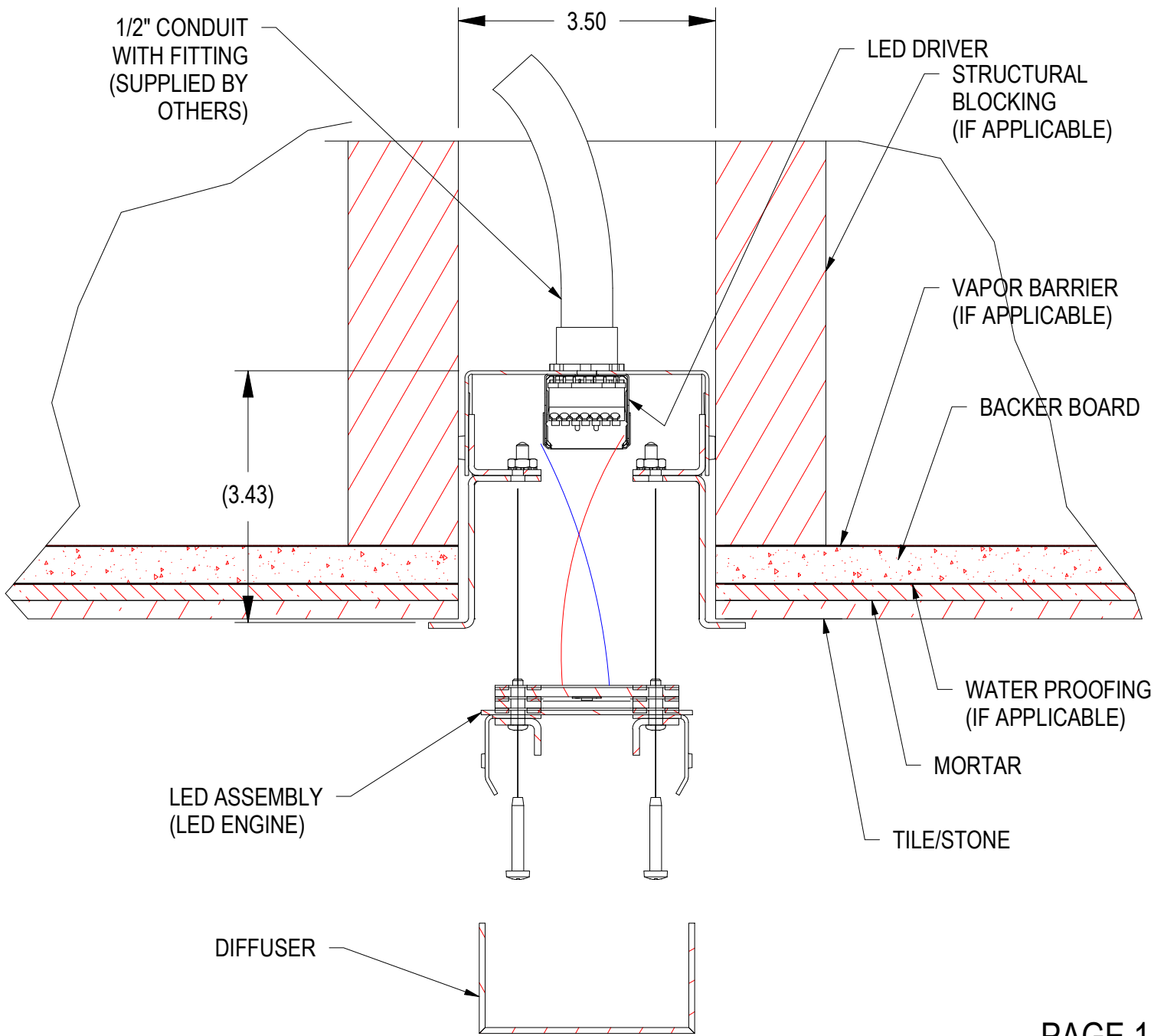

PAGE 1

05/05/23  
IS114731X

# IMPORTANT SAFETY AND INSTALLATION INSTRUCTIONS

**WARNING:** Risk of fire and electrical shock. This product is to be installed by a qualified electrician only.

**CAUTION:** When using electrical equipment, basic safety precautions should always be followed including the following: Read all instructions carefully before installation and save

for future use. Make sure installation and all connections are in accordance with National Electrical Code and any local regulations. To avoid possible electrical shock, be sure that power supply is turned off before installing or servicing this fixture. Servicing should be performed by qualified service personnel.

These instructions do not claim to cover all details or variations. When additional information is desired, please contact your SPI representative.

## FLANGE HOUSING - WALL/CEILING SYSTEM INTEGRATION

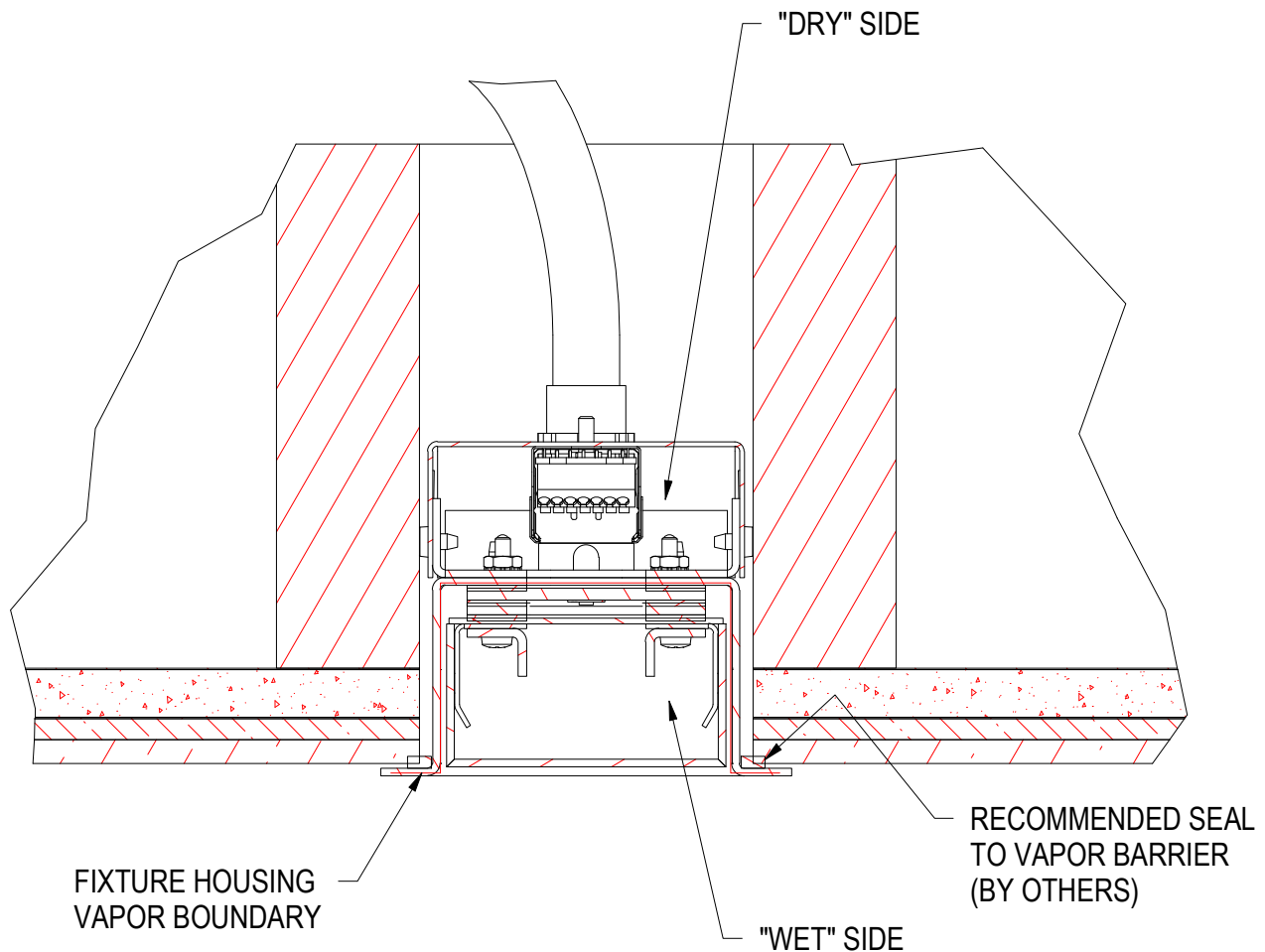

### VAPOR BARRIER BOUNDARY

To insure building performance integrity, the fixture is to be integrated into any required vapor barrier system. Fixture housing to be sealed to vapor barrier system with methods recommended by system manufacturer.

PAGE 2

05/05/23  
IS114731X

# IMPORTANT SAFETY AND INSTALLATION INSTRUCTIONS

**WARNING:** Risk of fire and electrical shock. This product is to be installed by a qualified electrician only.

**CAUTION:** When using electrical equipment, basic safety precautions should always be followed including the following: Read all instructions carefully before installation and save

for future use. Make sure installation and all connections are in accordance with National Electrical Code and any local regulations. To avoid possible electrical shock, be sure that power supply is turned off before installing or servicing this fixture. Servicing should be performed by qualified service personnel.

These instructions do not claim to cover all details or variations. When additional information is desired, please contact your SPI representative.

## FLANGE HOUSING - MOUNTING OPTION A (TO SURFACE)

### INSTALLATION INSTRUCTIONS

#### STEP 1

Determine the appropriate mounting method from Mounting Options A - D. Prepare rough opening and structural blocking for chosen option.

**NOTE:** Fixture may be installed in wall or ceiling, in any orientation (horizontal, vertical, etc.)

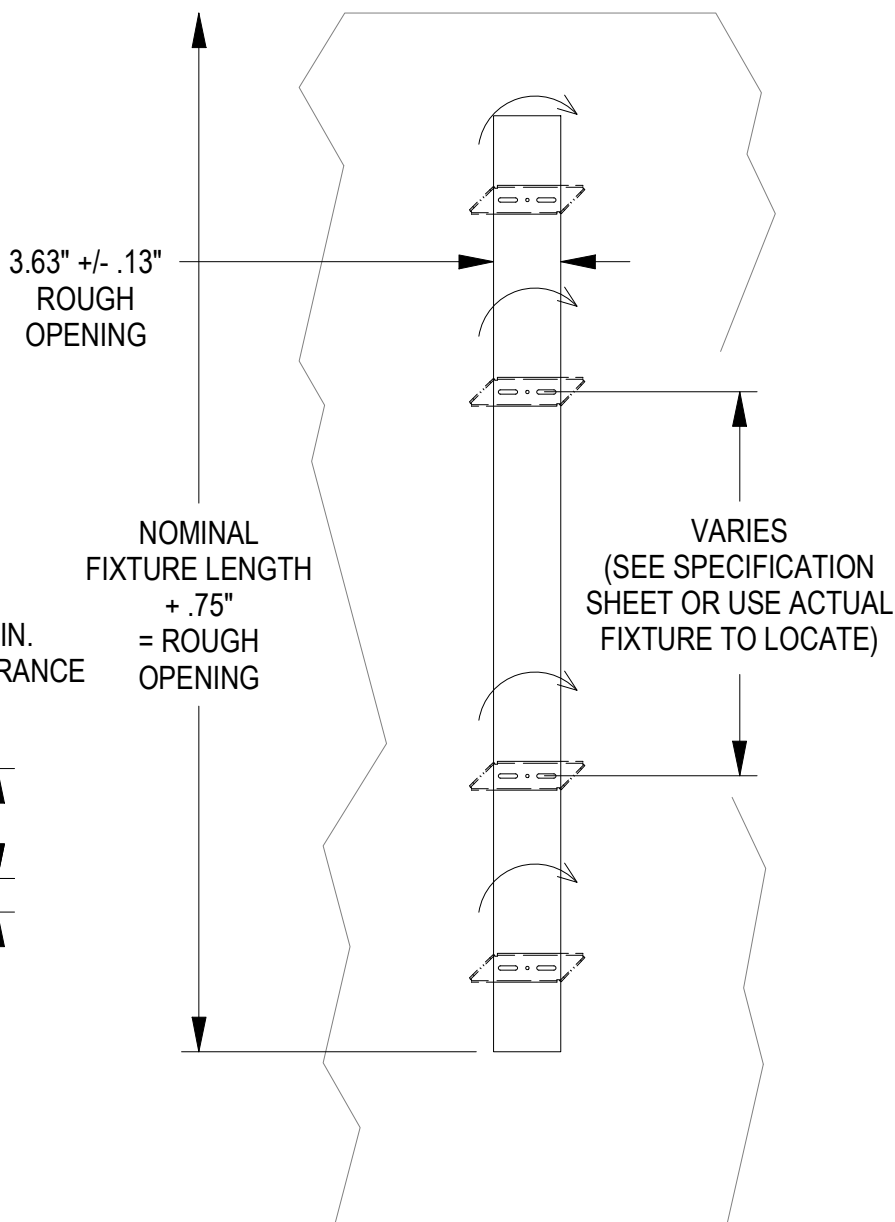
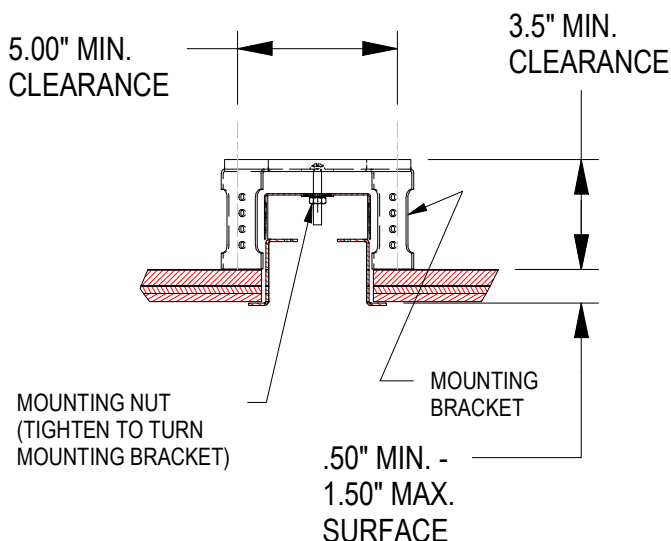

A

SURFACE SUPPORTING WITH PIVOT MOUNTING BRACKET

**MOUNTING SURFACE DETAIL**  
(SURFACE SUPPORT)

**PAGE 3**

05/05/23  
IS114731X

# IMPORTANT SAFETY AND INSTALLATION INSTRUCTIONS

**WARNING:** Risk of fire and electrical shock. This product is to be installed by a qualified electrician only.

**CAUTION:** When using electrical equipment, basic safety precautions should always be followed including the following: Read all instructions carefully before installation and save

for future use. Make sure installation and all connections are in accordance with National Electrical Code and any local regulations. To avoid possible electrical shock, be sure that power supply is turned off before installing or servicing this fixture. Servicing should be performed by qualified service personnel.

These instructions do not claim to cover all details or variations. When additional information is desired, please contact your SPI representative.

## FLANGE HOUSING - MOUNTING OPTIONS B-D (TO STRUCTURE)

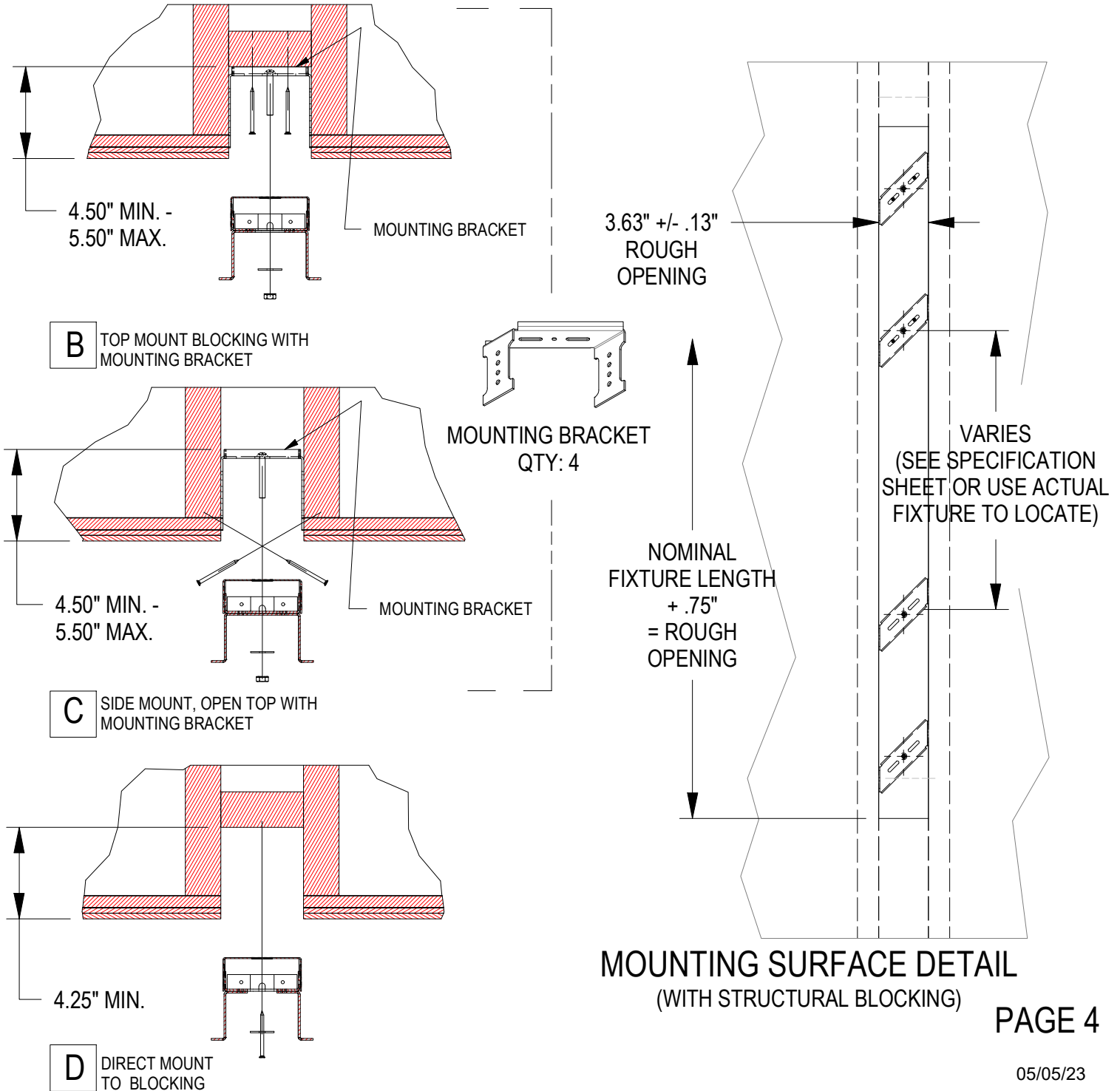

PAGE 4

05/05/23  
IS114731X

# IMPORTANT SAFETY AND INSTALLATION INSTRUCTIONS

**WARNING:** Risk of fire and electrical shock. This product is to be installed by a qualified electrician only.

**CAUTION:** When using electrical equipment, basic safety precautions should always be followed including the following: Read all instructions carefully before installation and save

for future use. Make sure installation and all connections are in accordance with National Electrical Code and any local regulations. To avoid possible electrical shock, be sure that power supply is turned off before installing or servicing this fixture. Servicing should be performed by qualified service personnel.

These instructions do not claim to cover all details or variations. When additional information is desired, please contact your SPI representative.

## FLANGE HOUSING

### STEP 2

Unpack Fixture to prepare for installation.

Remove acrylic Diffuser by carefully prying near the edges of the Diffuser at the end. Avoid prying in the center part of the end as this may crack the diffuser.

Unthread the phillips screws holding the LED Assembly to the Housing. Lift out LED Assembly and disconnect wires.

If Mounting Option B or C has been chosen, remove mounting brackets from Housing. Install mounting brackets onto structural blocking within the recessed cutout in wall or ceiling.

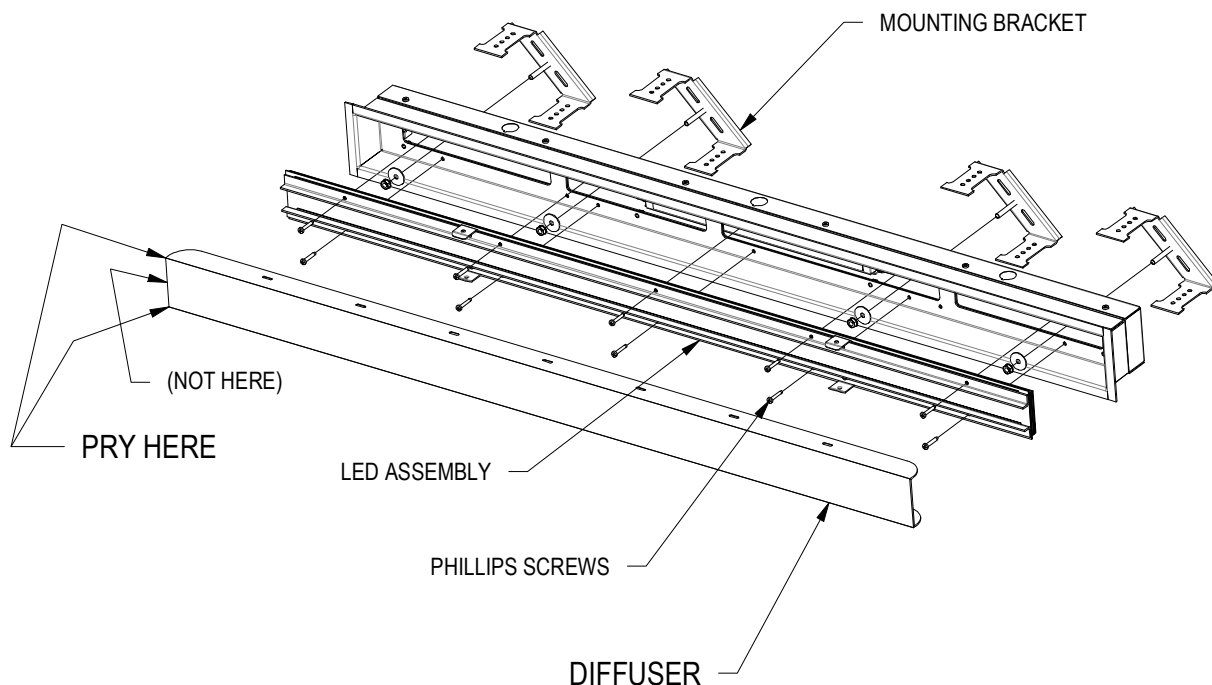

PAGE 5

05/05/23  
IS114731X

# IMPORTANT SAFETY AND INSTALLATION INSTRUCTIONS

**WARNING:** Risk of fire and electrical shock. This product is to be installed by a qualified electrician only.

**CAUTION:** When using electrical equipment, basic safety precautions should always be followed including the following: Read all instructions carefully before installation and save

for future use. Make sure installation and all connections are in accordance with National Electrical Code and any local regulations. To avoid possible electrical shock, be sure that power supply is turned off before installing or servicing this fixture. Servicing should be performed by qualified service personnel.

These instructions do not claim to cover all details or variations. When additional information is desired, please contact your SPI representative.

## FLANGE HOUSING

### STEP 3

Attach conduit (by others) and conduit fitting (by others) to Housing. Use factory knock-outs or punch new hole as needed to clear obstacles. Feed through branch circuit wires (by others.)

Apply recommended seal between housing and vapor barrier. (This may be a sealing compound, tape, caulk, or other method recommended by the vapor barrier manufacturer.)

Position housing into recessed slot and secure with washer and lock nuts. Clean up any exposed sealant.

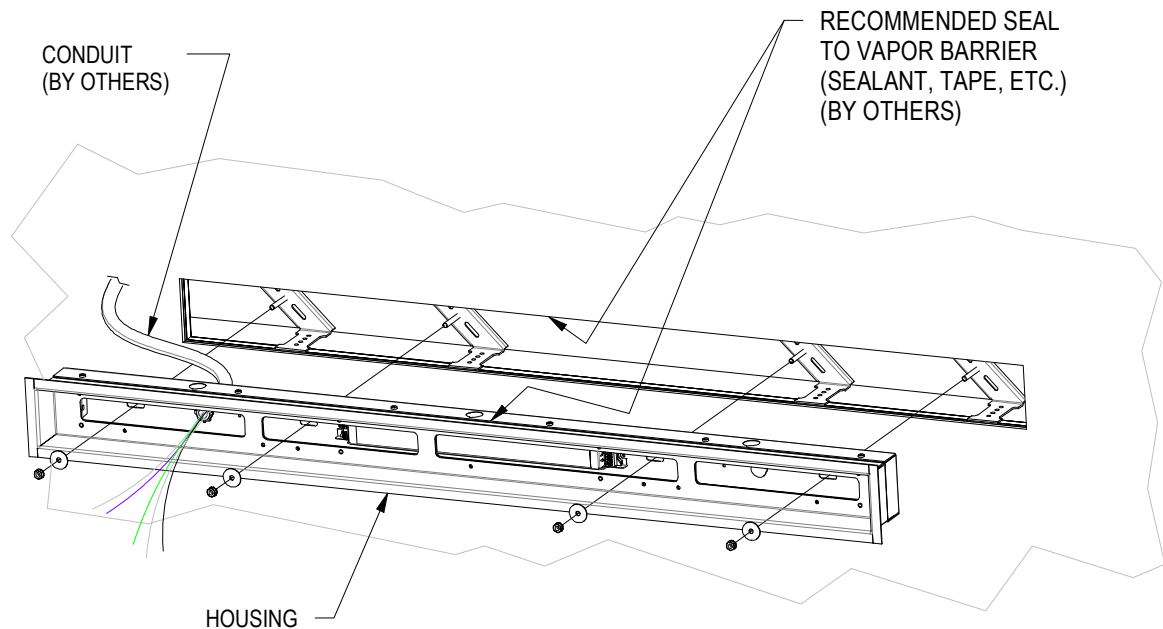

# IMPORTANT SAFETY AND INSTALLATION INSTRUCTIONS

**WARNING:** Risk of fire and electrical shock. This product is to be installed by a qualified electrician only.

**CAUTION:** When using electrical equipment, basic safety precautions should always be followed including the following: Read all instructions carefully before installation and save

for future use. Make sure installation and all connections are in accordance with National Electrical Code and any local regulations. To avoid possible electrical shock, be sure that power supply is turned off before installing or servicing this fixture. Servicing should be performed by qualified service personnel.

These instructions do not claim to cover all details or variations. When additional information is desired, please contact your SPI representative.

## FLANGE HOUSING

### STEP 4

Complete wiring from branch circuit to line voltage and dimming circuits within housing. Cap any unconnected line voltage wires and any unused dimming leads.

Neatly bundle wiring to prevent pinches when installing LED Assembly.

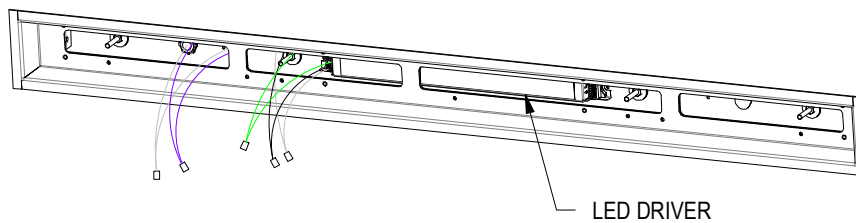

### STEP 5

Connect LED lead wires to LED driver. Place LED Assembly within Housing, being careful not to pinch any wires.

Double check for any pinch wires then secure LED Assembly to Housing with phillips screws.

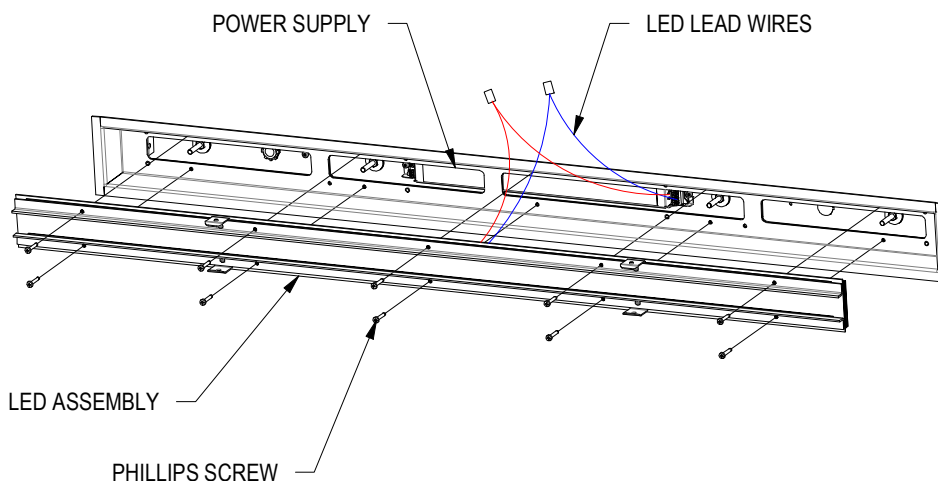

PAGE 7

05/05/23  
IS114731X

# IMPORTANT SAFETY AND INSTALLATION INSTRUCTIONS

**WARNING:** Risk of fire and electrical shock. This product is to be installed by a qualified electrician only.

**CAUTION:** When using electrical equipment, basic safety precautions should always be followed including the following: Read all instructions carefully before installation and save

for future use. Make sure installation and all connections are in accordance with National Electrical Code and any local regulations. To avoid possible electrical shock, be sure that power supply is turned off before installing or servicing this fixture. Servicing should be performed by qualified service personnel.

These instructions do not claim to cover all details or variations. When additional information is desired, please contact your SPI representative.

## FLANGE HOUSING

### STEP 6

Test fixture operation.

Check Housing for any gaps where water to pass through. Seal gaps as needed.

Install diffuser by placing legs of the diffuser between the housing wall and the retaining brackets. Carefully press diffuser into housing until it bottoms.

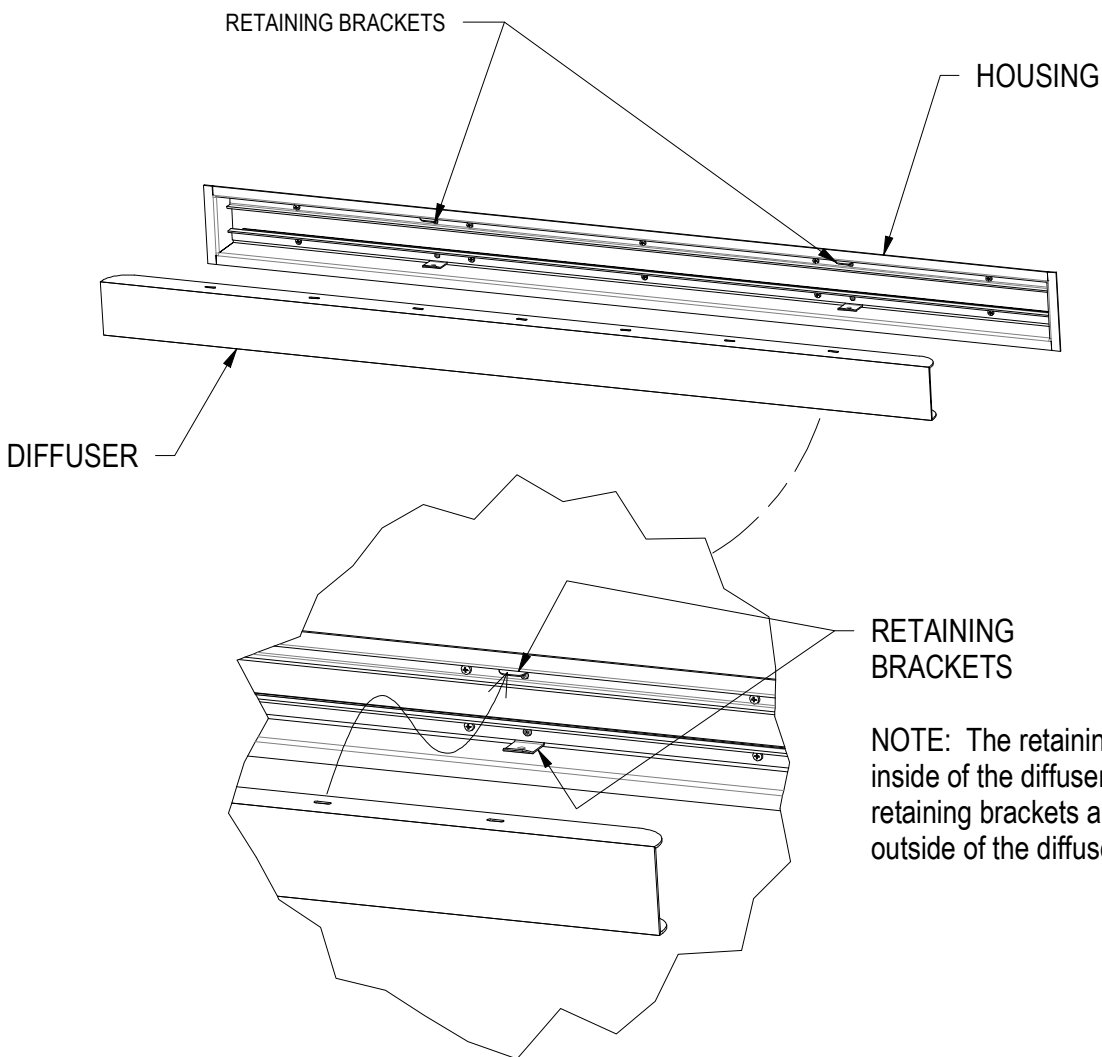

**NOTE:** The retaining brackets go to the inside of the diffuser. Make sure no retaining brackets are visible on the outside of the diffuser.

PAGE 8

05/05/23  
IS114731X