

INACTIVE SPEC SHEET

Marbles - Circle

AIW8369 12.00 in

SPILIGHTING

PROJECT DETAILS

JOB NAME:

TYPE:

NOTES:

DESCRIPTION

The Marbles series of wall sconces is perfect for unique, themed, or playful spaces. To create the look, eight marble colors are arranged randomly between 1/8" aluminum plates, producing a one-of-a-kind design for every fixture. An internal tempered, prismatic glass lens diffuses any view through the marbles. Meets ADA requirements. Choose from a palette of painted and metal finishes.

FEATURES & BENEFITS

- Iridescent glass marbles, in multiple colors, provide the ability to create a design in a unique and expressive fixture
- Choose a random marble configuration or contact factory to design a custom pattern
- Compliant with Americans with Disabilities Act (ADA) requirements
- Handcrafted in USA

SPECIFICATIONS

- **LIGHT SOURCE:** White LED light engine or incandescent
- **LUMEN MAINTENANCE (LED):** L70 = >50,000 Hrs.
- **CCT:** Available LED color temperatures: 3000K, 3500K, or 4000K
- **DRIVER:** LED versions feature integral Class II power supply standard
- **DIMMING:** 0-10V controls standard to 1% on LED light engines
- **EMERGENCY:** Emergency battery remote optional
- **LENS:** An internal tempered, prismatic glass lens diffuses any view through the marbles. Top lens and bottom lens standard with any LED module.
- **CONSTRUCTION:** Formed metal construction provides durable protection for internal components and is recyclable
- **MOUNTING:** Mounts to standard 4" octagonal junction box
- **MODIFICATIONS:** Consult factory for all modification requests
- **APPROVALS:** ETL listed to UL standards (US & Canada) for use in damp locations; not recommended for exterior applications

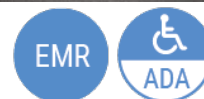
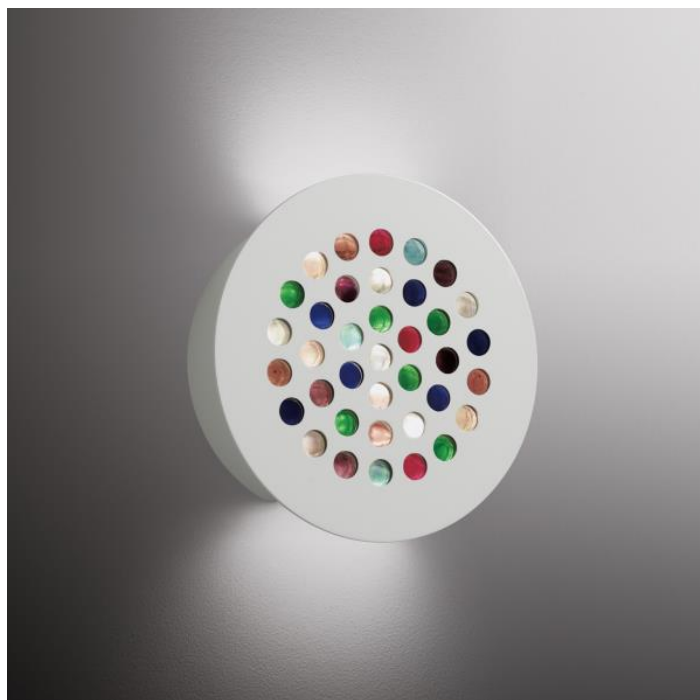

DIMENSIONS

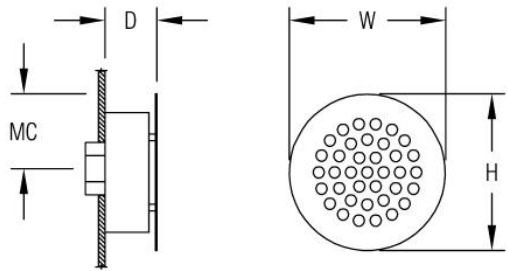

W	H	D	MC
12 in	12 in	4 in	6 in
30.5 cm	30.5 cm	10.2 cm	15.2 cm
Mounting Weight Approximate: 25 lb (12 kg)			

CONFIGURATOR

To configure your spec sheet online, go to www.spilighting.com/AIW8369. Not all options are available in all configurations; consult factory for details.

Required Field *

Catalog	Light Source*	Primary Finish*	Voltage*	Lamp Options*
AIW8369				
	A		B	C

A - LIGHT SOURCE *

To ensure color consistency, SPI uses precise bin selection and strict quality processes to maintain a 3-step (MacAdam) SDCM on all white LED lampings. Published LED luminaire wattages are calculated using a typical power supply efficiency of 88%; exact wattages may vary based on application. Alternative wattages available upon request.

- ☐ **L7W** | White 7W LED Light Engine
- ☐ **L14W** | White 14W LED Light Engine
- ☐ **2N60** ¹ | 2INC60W/T10/MED

See last page for finish options

¹ Incandescent Lamp(s) Not Included

B - VOLTAGE *

- ☐ **120-277V** | Universal Voltage
- ☐ **120V** ² | 120 Volt

² For incandescent light source only

C - LAMP OPTIONS *

Delivered lumens shown are at 4000K CCT; apply multiplier for delivered lumens at other CCT.

- ☐ 3000K ³ | 3000K CCT
- ☐ 3500K ⁴ | 3500K CCT
- ☐ 4000K | 4000K CCT

³ Apply .95 multiplier for delivered lumens

⁴ Apply .97 multiplier for delivered lumens

Standard Finishes

The colors shown are representative. Their actual appearance may vary due to differences in display settings. You can request color chips by emailing contact@spilighting.com. Please note, finishes may not be available in all configurations.

Paint Colors

PT01 RAL9003 Signal White (Gloss)	PT51 Matte White (Textured)	PT02 White (Textured)	PT04 RAL9001 Cream (Textured)	PT11 Black (Textured)
---	---------------------------------------	---------------------------------	---	---------------------------------

Metallic Paint Colors

PT22 Platinum (Metallic Gloss)	PT48 Brass (Metallic Textured)	PT28 Dark Stainless (Metallic Gloss)	PT49 Bronze (Metallic Textured)	PT32 Dark Bronze (Metallic Gloss)
PT46 Aluminum (Metallic Textured)				

Brushed Aluminum

BAL Brushed Aluminum

Specialty Finishes



More RAL®, Pantone®, and custom finishes are available upon request. Setup fee and additional lead time applies. Call factory for details.